



BA 人體紅外感應器

使用說明書

型號：P-S-IR-IMT

VEGA Integration Corp. (Japan)

聲明

VEGA 為 VEGA Integration Corp. (Japan) 的註冊商標，我司保留本說明書內容的全部權利，任何人不得以任何形式用於商業用途，包括但不限於拷貝、複製、印刷、掃描等。

我們將持續不斷的技術升級，最新訊息請查閱 <http://www.vega-tech.co.jp>

VEGA Integration Corp. (Japan)

日本 〒530-0043
大阪市北区天満二丁目1-12天満橋SEビル4F

台北辦公室 100
台北市中正區忠孝東路一段9號9樓

www.vega-tech.co.jp

使用指南

本產品需通過VEGA手機客戶端與智能網關配合使用，具體操作請參閱VEGA手機客戶端說明書。(請登入VEGA官方網站www.vega-tech.co.jp/support#app進行查看)



APP下載

產品簡介

人體紅外感應器具有人體紅外檢測以及光照強度測量功能。該產品擁有兩種工作模式，分別是雲端管理平台連動燈光控制模式和安防入侵警報模式。當設備檢測到紅外感應資料和光照強度資料滿足設定值後，設備上傳檢測資訊，雲端平台根據監測資訊和控制邏輯，自行判斷並向關聯的控制器發送開關燈命令，實現照明控制，有效減少耗能；安防入侵警報模式，在佈防狀態下檢測到人體移動，通過平台可即時向移動用戶端通知入侵警報資訊，避免損失。

技術參數

工作電壓：100-240V~
工作頻率：50/60Hz
最大感應距離：7m
感應角度：120°
待機功耗：小於0.5W
光強範圍：0LUX~1000LUX
通訊方式：電力線載波
工作溫度：-10°C~55°C
相對濕度：10% ~ 85%RH
外型尺寸：54.97(R)x45.54mm(H)

安裝指南

1. 紀錄產品標籤二維條碼下方的設備地址和密碼，首次添加設備到網關時使用。
2. 將卡扣卡在人體感應器兩側相對位置，如下圖。
將彈簧夾下方伸出來的小彎頭1插入彈簧夾固定柱下方的縫隙2，然後將彈簧夾套在彈簧夾固定柱上，完成彈簧夾的裝配。

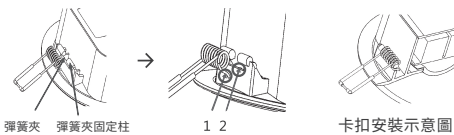

3. 產品接線圖：

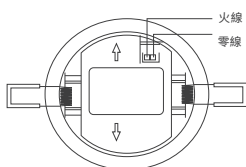

產品接線圖

註：殼體箭頭方向為檢測靈敏方向

4. 將人體感應器的彈簧夾上掰，插入預先留好的安裝孔上卡緊即可。

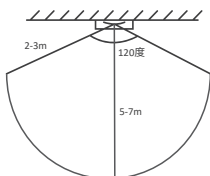

註：感應效果與環境溫度、人體體型、移動速度有關

包裝清單

BA 人體紅外感應器	1個
彈簧夾	2個
說明書	1份

注意事項

安裝前請仔細閱讀說明書，嚴格按照說明書規定進行操作，避免造成設備故障或安全事故。

※本產品採用零火線供電，安裝處需預留零、火線。

※嚴禁帶電安裝或拆機檢查。

※請勿將產品放置在潮濕或有水的地方。

※避免安裝在熱源附近，如空調出風口、暖氣出風口、加濕器等溫度變化劇烈的位置，避免安裝在強光直射的位置。



PIR Sensor
Manual
P-S-IR-IMT

VEGA Integration Corp. (Japan)

Statement

 VEGA is the trademark of VEGA Integration Corp. (Japan) All rights reserved. No part of this document may be reproduced, distributed, or transmitted in any form or by any means, including photocopying, recording, or other electronic or mechanical methods, without the prior written consent of the company.

VEGA Integration Corp. (Japan) regularly releases functional and technology upgrades that offer a range of improvements addressing performance enhancement and security. Please refer to the following website for the latest news at <http://www.vega-tech.co.jp>

VEGA Integration Corp. (Japan)

JAPAN	TenmabasiSE Bld.4F, 2-1-12, Temma, Kita-ku Osaka-shi, Osaka, 530-0043, Japan
Branch office Taipei	9F, No.9, Section 1, Zhongxiao East Road, Zhongzheng District, Taipei City 100, Taiwan

www.vega-tech.co.jp

Guidance

This device is to be used with the VEGA Smart App and VEGA Smart PLC Network. For more information, please refer to the VEGA Smart App manual(VEGA official website:www.vega-tech.co.jp/-support#app)



APP download

Introduction

PIR sensor has human infrared detection and light intensity measurement functions. The product has two working modes, namely the cloud management platform linked light control mode and security alert mode. When the device detects that the infrared sensing data and the light intensity data meet the set values, the device uploads the detection information, and the cloud platform judges and sends the light switch command to the associated controller based on the monitoring information and control logic to achieve lighting control and effectively reduce power consumption. Security alert mode, human movement is detected in the state of arming, and the platform can immediately notify the mobile client of intrusion alert information to avoid loss.

Specification

Operation Voltage: 100-240V~
Operation Frequency: 50/60Hz
Maximum sensing distance: 7m
Induction angle: 120°
Power Consumption: < 0.5W
Light intensity range: 0LUX~1000LUX
Communication: Power Line Communication (PLC)
Operation Temperature: -10°C~55°C
Operation Humidity: 10% ~ 85%RH
Dimensions: 54.97(R)x45.54mm(H)

Installation Guide

1. Document the IP address and password under the QR code of the label which are necessary when adding device to the gateway for the first time.
2. Place the clips on the opposite sides of the body sensor, as shown below.
Insert the small elbow 1 protruding below the spring clip into the gap 2 below the spring clip fixing post, and then place the spring clip on the spring clip fixing post to complete the assembly of the spring clip.

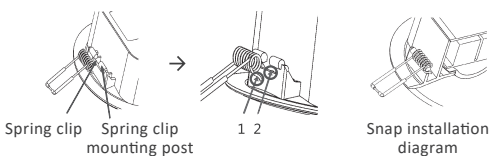

3. Product wiring diagram:

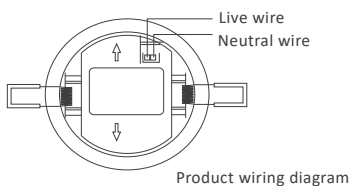

Note: The direction of the arrow of the casing is the detection sensitive direction

4. Insert the spring clip of the PIR sensor and insert it into the mounting hole reserved in advance.

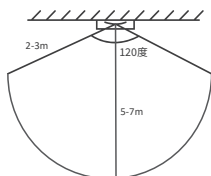

Note: The sensing effect is related to the ambient temperature, body shape, and moving speed

Package Contents

PIR Sensor	1
Spring clip	2
Instruction	1

Precautions

Please read the instruction before the installation and follow the steps strictly to prevent from any equipment failure or safety accident.

- This product adopts neutral wire and live wire for power supply. The installation place needs to reserve neutral wire and live wire.
- To install or disassemble with power is strictly prohibited.
- Don't place the product in a humid or watery place.
- Avoid installing near the heat source, such as air-conditioning outlets, humidifiers and other places where the temperature changes drastically, and avoid installing in a place with direct sunlight.